

T&B® Fittings



T&B Catalog Number: 2547
UPC Number: 78621002547
Description: 1" Liquidtight Strain Relief Cord Connector-Straight; Body Material-Die Cast Zinc; Gland material-Steel; Bushing-Neoprene. Cord range-.875-.985
Status: Active

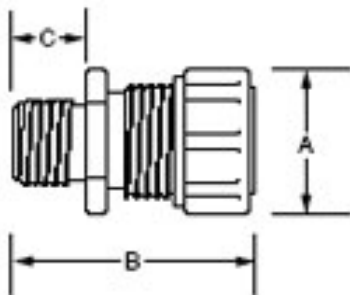

Fig. 1

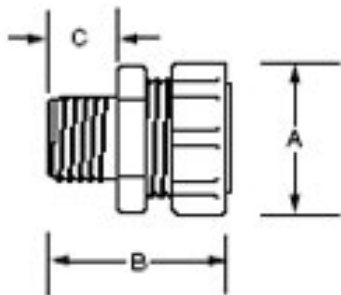

Fig. 2

General

Material Die Cast Zinc

Dimension Information

| | |
|--------------------------|-----------|
| Hub Size (inches) | 1 |
| Dimension A (inches) | 1 11/16 |
| Dimension B (inches) | 1 7/8 |
| Dimension C (inches) | 9/16 |
| Cord Range (inches) | .875-.985 |
| Throat Diameter (inches) | 63/64 |

Packaging

| | |
|--------------------|-------------------|
| T&B Inner Pack | 10 |
| Package in Units | 100 |
| T&B Sold in UOM | Each |
| T&B Weight Per UOM | 29.2 lbs. per 100 |

Application Support

| | |
|---|----------------------|
| Product Overview | Available on Website |
| Specifications | Available on Website |
| Liquidtight Flexible Cord and Cable Connectors-Application and Features | Available on Website |
| Portable Cord Selection Table | Available on Website |

Notes

| | |
|----------|--|
| *Note | Suitable for use in hazardous locations where general purpose equipment is specifically permitted by NEC 501-4(b). |
| **Note | Meets Coast Guard CG293 |
| ****Note | Temperature rating-105° C |

Certifications

| | |
|-----------------|-----|
| RoHS Compliance | Yes |
|-----------------|-----|

Certifications



File Nbr:
E 13938

T&B Conduit Fittings

Flexible Cord and cable Fittings

Specifications—Liquidtight Flexible Cord and Cable Fittings



2520 Series



2631 Series

Application

- A liquidtight fittings to connect flexible cord or power cable to a box or enclosure and provide adequate strain relief.

Features

- Liquidtight connection with box or enclosure is assured by:
 - (1) Taper threaded hub on 2520 series for female hub application (A).
 - (2) Using sealing ring series 5262 with 2520 series for knockout application (B).
 - (3) Captivated sealing 'O' ring on 2631 series (C).
- Neoprene bushing makes liquidtight installation; applies pressure against cable the full length of bushing (D).
- Thermoplastic or stainless steel retaining ring (E).
 - (1) Will not abrade cord/cable jacket.
 - (2) Reduces installing torque effort.
- U.L. Listed for liquidtightness, strain relief and as an outlet bushing; CSA certified watertight.

Standard Material

| | |
|----------------|---------------------------------------|
| Gland, Body | Steel/Malleable Iron/Zinc Die Cast |
| Retaining Ring | Thermoplastic/ Stainless Steel |
| Bushing | Neoprene |
| 'O' Ring | Buna N |

Standard Finish

Electro Zinc Plated & Chromate Coated

Range

- 2520 Series, straight
0.125" outside diameter to 3.200" outside diameter Cord or Cable
- 2200 Series, 45°
0.125" outside diameter to 1.485" outside diameter Cord or Cable
- 2267 Series, 90°
0.125" outside diameter to 1.875" outside diameter Cord or Cable
Cord/Cable Type S, SO, SV, ST, STO, SJ, SJO, SJT, SJTO, SVO & SVT

Conformity

U.L. 514
CSA C22.2 No. 18
ANSI C33.84
NFPA 70-2002 (ANSI)

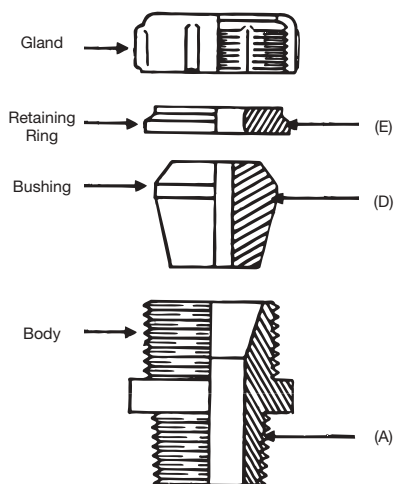

2520 Series

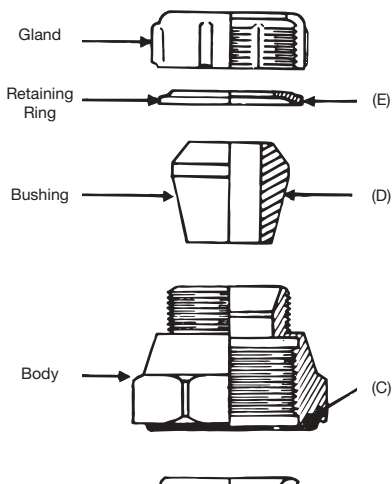

2631 Series

T&B Conduit Fittings

Flexible Cord and Cable Fittings

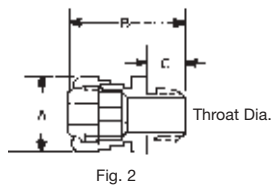
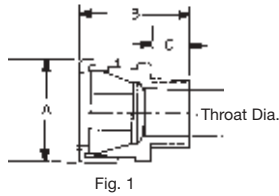

Liquidtight Strain Relief Fittings

| Cat. No. | Cable Size Range min.-max. | Hub Size | Throat Dia. (min.) | Fig. | Dimensions (in.) | | |
|--------------------|-------------------------------|----------|-----------------------|------|------------------|---------|--------|
| | | | | | A | B | C |
| 2516 [†] | (.060-.125) | 1/4" | 23/64" | 2 | 53/64 | 1-7/16 | 15/32 |
| 2517 [†] | (.120-.250) | 1/4" | 23/64" | 2 | 53/64 | 1-7/16 | 15/32 |
| 2518 [†] | (.060-.150) | 3/8" | 29/64" | 2 | 31/32 | 1-1/2 | 15/32 |
| 2519 ^{**} | (.150-.300) | 3/8" | 29/64" | 2 | 31/32 | 1-1/2 | 15/32 |
| 2520 | (.125-.250) | 1/2" | 9/16" | 1 | 1-5/32 | 1-11/16 | 5/8 |
| 2521 | (.250-.375) | 1/2" | 9/16" | 1 | 1-5/32 | 1-11/16 | 5/8 |
| 2522 | (.375-.500) | 1/2" | 9/16" | 1 | 1-5/32 | 1-11/16 | 5/8 |
| 2523 | (.450-.560) | 1/2" | 9/16" | 1 | 1-5/32 | 1-11/16 | 5/8 |
| 2524 [*] | (.500-.625) | 1/2" | 5/8" | 1 | 1-3/8 | 1-3/4 | 5/8 |
| 2525 [*] | (.625-.750) | 1/2" | 5/8" | 1 | 1-3/8 | 1-3/4 | 5/8 |
| 2530 | (.125-.250) | 3/4" | 13/16" | 1 | 1-3/8 | 1-3/4 | 9/16 |
| 2531 | (.250-.375) | 3/4" | 13/16" | 1 | 1-3/8 | 1-3/4 | 9/16 |
| 2532 | (.375-.500) | 3/4" | 13/16" | 1 | 1-3/8 | 1-3/4 | 9/16 |
| 2534 | (.500-.625) | 3/4" | 13/16" | 1 | 1-3/8 | 1-3/4 | 9/16 |
| 2535 | (.625-.750) | 3/4" | 13/16" | 1 | 1-3/8 | 1-3/4 | 9/16 |
| 2536 [*] | (.750-.880) | 3/4" | 3/4" | 1 | 1-11/16 | 1-15/16 | 5/8 |
| 2541 | (.250-.375) | 1" | 49/64" | 1 | 1-3/8 | 1-23/32 | 9/16 |
| 2542 | (.375-.500) | 1" | 49/64" | 1 | 1-3/8 | 1-23/32 | 9/16 |
| 2544 | (.500-.625) | 1" | 49/64" | 1 | 1-3/8 | 1-23/32 | 9/16 |
| 2545 | (.625-.750) | 1" | 49/64" | 1 | 1-3/8 | 1-23/32 | 9/16 |
| 2546 | (.750-.875) | 1" | 63/64" | 1 | 1-11/16 | 1-7/8 | 23/32 |
| 2547 | (.875-.985) | 1" | 63/64" | 1 | 1-11/16 | 1-7/8 | 9/16 |
| 2548 [*] | (.880-1.065) | 1" | 29/32" | 1 | 2-3/32 | 2-3/8 | 25/32 |
| 2549 [*] | (1.065-1.205) | 1" | 29/32" | 1 | 2-3/32 | 2-3/8 | 25/32 |
| 2558 | (.880-1.065) | 1-1/4" | 1-17/64" | 1 | 2-3/32 | 2-5/32 | 13/16 |
| 2559 | (1.065-1.205) | 1-1/4" | 1-17/64" | 1 | 2-3/32 | 2-5/32 | 13/16 |
| 2556 [*] | (1.187-1.375) | 1-1/4" | 1-1/4" | 1 | 2-11/32 | 2-1/2 | 13/16 |
| 2557 [*] | (1.375-1.485) | 1-1/4" | 1-1/4" | 1 | 2-11/32 | 2-1/2 | 13/16 |
| 2562 | (.812-1.000) | 1-1/2" | 1-7/16" | 1 | 2-11/32 | 2-1/2 | 11/16 |
| 2563 | (1.000-1.187) | 1-1/2" | 1-7/16" | 1 | 2-11/32 | 2-7/16 | 11/16 |
| 2564 | (1.187-1.375) | 1-1/2" | 1-7/16" | 1 | 2-11/32 | 2-7/16 | 11/16 |
| 2565 [*] | (1.375-1.625) | 1-1/2" | 1-29/64" | 1 | 2-13/16 | 2-5/8 | 13/16 |
| 2573 | (1.125-1.375) | 2" | 1-7/8" | 1 | 2-13/16 | 2-5/8 | 13/16 |
| 2574 | (1.375-1.625) | 2" | 1-7/8" | 1 | 2-13/16 | 2-5/8 | 11/16 |
| 2575 | (1.625-1.875) | 2" | 1-7/8" | 1 | 2-13/16 | 2-5/8 | 11/16 |
| 2576 [*] | (1.750-1.965) | 2" | 1-29/32" | 1 | 3-7/32 | 3-1/2 | 27/32 |
| 2577 [*] | (1.937-2.187) | 2" | 1-29/32" | 1 | 3-7/32 | 3-1/2 | 27/32 |
| 2584 | (1.750-1.965) | 2-1/2" | 2" | 1 | 3-7/32 | 3-3/4 | 1-1/32 |
| 2585 | (1.937-2.187) | 2-1/2" | 2" | 1 | 3-7/32 | 3-3/4 | 1-1/32 |
| 2586 [*] | (2.156-2.360) | 2-1/2" | 2-5/32" | 1 | 3-15/16 | 4-1/4 | 1-1/32 |
| 2587 [*] | (2.350-2.565) | 2-1/2" | 2-5/32" | 1 | 3-15/16 | 4-1/4 | 1-1/32 |
| 2592 | (2.156-2.360) | 3" | 2-13/32" | 1 | 3-15/16 | 4-1/4 | 1-1/32 |
| 2593 | (2.350-2.565) | 3" | 2-13/32" | 1 | 3-15/16 | 4-1/4 | 1-1/32 |
| 2594 | (2.535-2.750) | 3" | 2-13/32" | 1 | 3-15/16 | 4-1/4 | 1-1/32 |
| 2595 [*] | (2.735-2.985) | 3" | 2-13/16" | 1 | 4-11/16 | 4-13/16 | 1-1/8 |
| 2596 [*] | (2.970-3.220) | 3" | 2-13/16" | 1 | 4-11/16 | 4-13/16 | 1-1/8 |

* Remove sufficient outer covering of cable to permit conductors to pass thru fitting body.

[†] U.L. not applicable.

** Not CSA Certified.

Complies with JIC standards.

U.L. Listed as liquidtight strain relief, and outlet bushing. CSA certified watertight.

Temperature rating: 105°C.